

2021-22 Student Parking Policy for Coronado High School

T-Bird Family,

It is a challenging time for our Coronado community as construction continues. The reality is that the current parking situation is limited. **This is especially true for students who will have 2 parking lots available where students may park:**

1. The new parking lot at the top of Thunderbird Alley next to portables
2. The new parking lot next to the softball field and Cloudview Park

Any student who currently has **enough credits to be listed as a junior or senior** will be able to apply for a parking permit. Please read the policy below for the criteria to be issued a permit:

1. The student is currently registered in the EPISD computer system as a junior/senior.
2. The vehicle must have a valid license plate and student a valid driver's license.
3. Students must provide proof of active car insurance.

Guidelines for students who are issued a permit:

1. Student must obtain a parking permit prior to parking on campus.
2. Specific start dates will be announced through all school media outlets.
3. The permit must be adhered to the windshield behind the review mirror.
4. Vehicles are parked on campus at the owner's risk.
5. Students can only park in designated lots/parking spaces assigned to students.

There are a limited number of parking spaces for students. Any senior or junior who qualifies will be issued a permit for their vehicle. There will be a significant number more student permits issued than parking spaces for those permits. **Students who arrive late to campus will not be able to park on campus even though they have a parking permit.**

Violations which may result in consequences but are not limited to:

1. Parking in an illegal area (handicap, fire lane, designated faculty or lined no parking)
2. Parking without a permit adhered to the wind shield.
3. Parking without a valid license plate on the vehicle.
4. Inappropriate or dangerous driving anywhere in the vicinity of the campus.

Possible Consequences:

1. Student receives warning from school administrator and parent/guardian is contacted.
2. Student is placed in lunch detention (*15 minutes*) or ISS (1 to 3 days)
3. Parking citation issued by EPISD police for parking illegally.
4. Revocation of the parking permit (no longer allowed to park on campus).
5. Vehicle towed at owner's expense

******Parking is a student privilege which may be revoked******

Thank you for understanding,
Your Coronado T-Bird Administration

Coronado Student Parking Application 2021-22 Permit # _____

Last Name _____ First Name _____ ID# _____ Grade Level _____

Student Driver License # _____ License Plate # _____ Car Make _____

Insurance Co. _____ Insurance Policy # _____ Police Expiration Date _____ Car Color _____

The above information is correct. We have received and read the rules regarding parking/driving on the Coronado High School campus. We agree to abide by the rules and understand that failure to do so may result in the loss of parking privilege or being towed.

We have read the parking policy and understand ***student parking on the Coronado campus is a privilege which can be revoked.*** We understand that repeated and serious parking offenses may result in ***a parking ticket and/or the towing of our vehicle.*** We understand that Coronado High School and the EPISD School Board are not responsible for theft, fire damage, vandalism and/or other mishaps which may occur while our vehicle is parked on the Coronado campus. We understand that we are responsible for any damage to other vehicles and property damaged as a result of our driving and parking on the Coronado campus.

Parent's Signature

Date

Student's Signature

Date

FACULTY PARKING

STUDENT PARKING

Lot #3 - Construction Yard for Main Building - Lost 175 spaces (re-gain in May 2023)

Lot #4 - D building Parking 50 Spaces

Lot #5 Stadium Parking Lot = 76 Spaces

Lot #6 Ag & Tennis Parking Lot = 82 Spaces

Lot #8 - Softball Field Parking Lot - 135 Spaces

New Building Construction Zone

Lot #2 -out of use by midyear - Already lost 35 spots and will lose remaining 40 spots in Spring 2022

Lot #7 - New Field House Construct Yard - Regain Summer 2022 Lost 40 Spaces

New Field House

New Bus Loop - Parking No Longer Available

Lot #1 - Portables Parking Lot 233 spaces

STUDENT PARKING

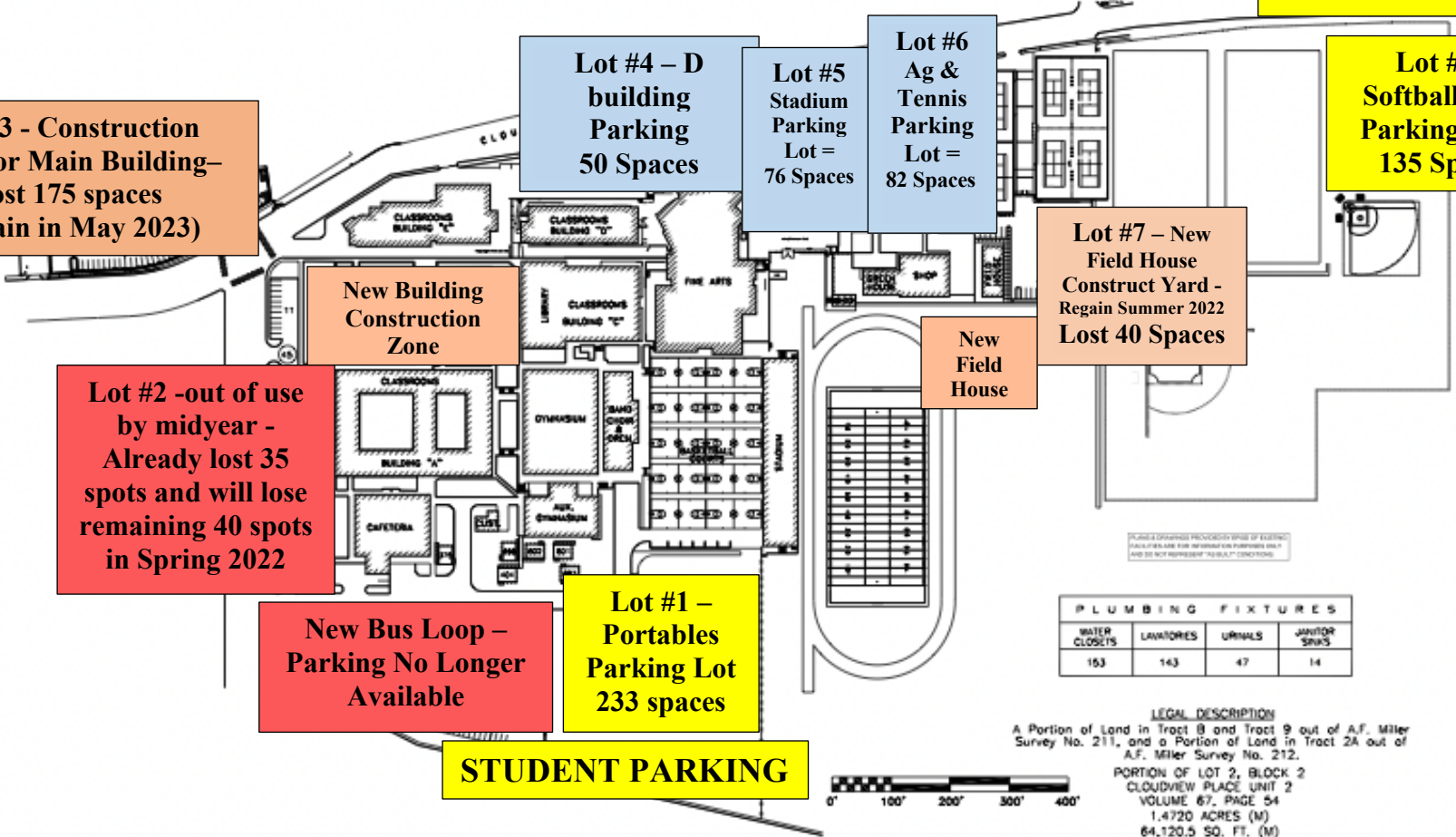

PLUMBING FIXTURES

WATER CLOSETS	LAVATORIES	URINALS	JANITOR SINKS
153	143	47	14

LEGAL DESCRIPTION
 A Portion of Land in Tract B and Tract 9 out of A.F. Miller Survey No. 211, and a Portion of Land in Tract 2A out of A.F. Miller Survey No. 212.
 PORTION OF LOT 2, BLOCK 2
 CLOUDVIEW PLACE UNIT 2
 VOLUME 67, PAGE 54
 1.4720 ACRES (M)
 64,120.5 SQ. FT. (M)



SITE PLAN
 CORONADO HIGH